

Ender-2 Pro

BOLD TO CREATE

Quick Assembly | Simple Operations | Light and Portable | Joy of DIY

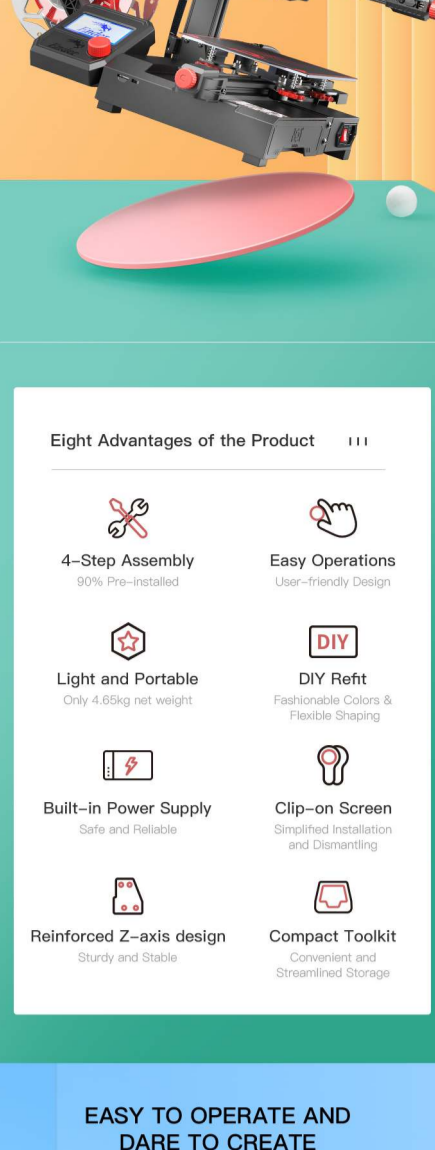

Eight Advantages of the Product



4-Step Assembly
90% Pre-installed



Easy Operations
User-friendly Design



Light and Portable
Only 4.65kg net weight



DIY Refit
Fashionable Colors & Flexible Shaping

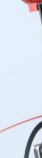

Built-in Power Supply
Safe and Reliable



Clip-on Screen
Simplified Installation and Dismantling



Reinforced Z-axis design
Sturdy and Stable



Compact Toolkit
Convenient and Streamlined Storage

EASY TO OPERATE AND DARE TO CREATE

7 User-friendly Designs at Your Fingertips
Even for novices, you can quickly get started and let the creativity flow.



LIGHT AND PORTABLE CARRY IT EVERYWHERE

As light as 4.65kg, with a size comparable to a desktop fan. Equipped with an easy-to-carry handle, its lightweight design makes it super easy to move.



QUICK ASSEMBLY IN FOUR STEPS

Ender-2 Pro comprehensively meets your needs for ease of assembly. The product is a 90% pre-installed device. You only need to tighten 7 screws. That is it!



CREATIVE REFIT JOY OF DIY

Fashion matching, to meet personalized needs; DIY handle design, free styling and color matching, burst your creativity.

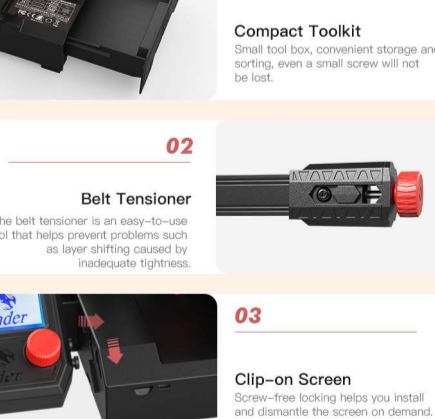
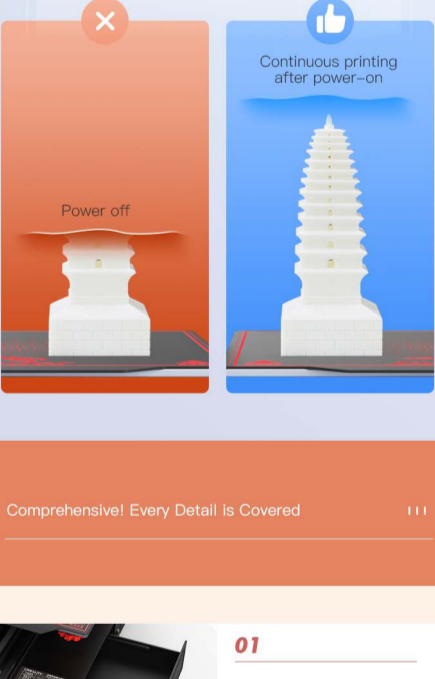

Come On! Discover More Functional Configurations

CANTILEVER STRUCTURE REINFORCED BY A FIXED BLOCK

The simplified, unique cantilever structure offers a lightweight design. With an extra Z-axis fixed block, it can support heavier loads and lean positioning, remaining stable throughout the entire printing process.



BUILT-IN POWER SUPPLY OPTIMAL RELIABILITY

Compared with other products with an exposed power supply, the integrated modular design comes with a built-in power supply to increase safety and reduce installation worries.

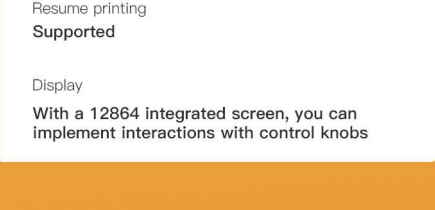

CONTINUOUS & RELIABLE PRINTING SAFEGUARD YOUR PRINTING FROM START TO FINISH

The resume printing function automatically saves your content in the event of a power failure, making your printing worry-free.

Interruption recovery

Resume printing
Stop printing

Comprehensive! Every Detail is Covered

Ender-2 Pro

Ender-2 Pro is a powerful device designed to stimulate your creative ideas. It has comprehensive features and an artisanal appearance. These help translate your imagination into reality at any time.

01

Compact Toolkit

Small tool box, convenient storage and sorting, even a small screw will not be lost.

02

Belt Tensioner

The belt tensioner is an easy-to-use tool that helps prevent problems such as layer shifting caused by inadequate tightness.

03

Clip-on Screen

Screw-free locking helps you install and dismantle the screen on demand.

04

Magnetic Sticker Platform

Strong magnetic force facilitates easy installation and mold.

05

Seamless Storage

The rack can be rotated back into place. Screen dismantling does not take up space. Compact design enables seamless storage.

SPECIFICATIONS

Molding technology FDM	Nozzle temperature ≤ 260°C
Printer dimensions 421*383*465 mm	Hotbed temperature ≤ 80°C
Build size 165*165*180 mm	Rated power 150W
Net weight 4.65 kg	Supported filament PLA/TPU/WOOD
Extrusion method Bowden extruder	Filament detector No
Leveling method Manual leveling	Printing speed ≤ 100 mm/s. Average printing speed: 60mm/s
Resume printing Supported	
Display With a 12864 integrated screen, you can implement interactions with control knobs	